

# Summary

**Project Name:** Electrical harnesses 3D Routing

**Scope:** Complex Electrical system designing done in NX for RT cranes and Control system

**Software:** NX Version 8

- Complex Electrical system designing done in NX for RT cranes and Control system
- Complexity in manufacturing taken care
- Wire length saved using the best routing path
- Bend curves avoided during routing
- Proper clamping and dressing items selected as per actual Outer diameter

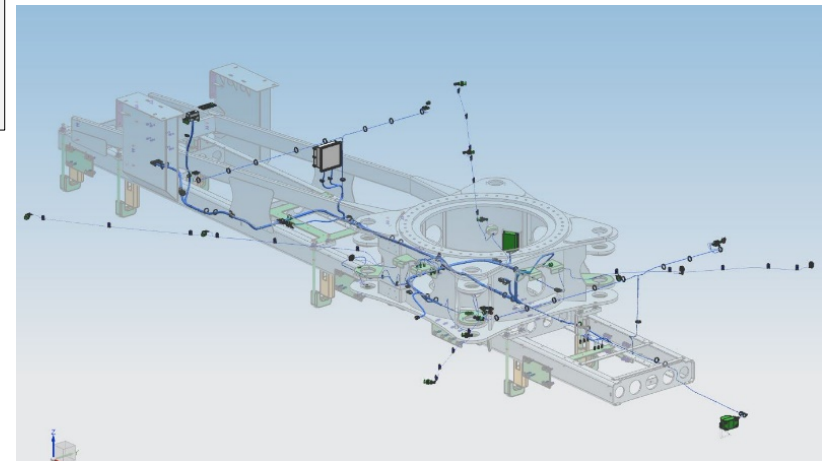
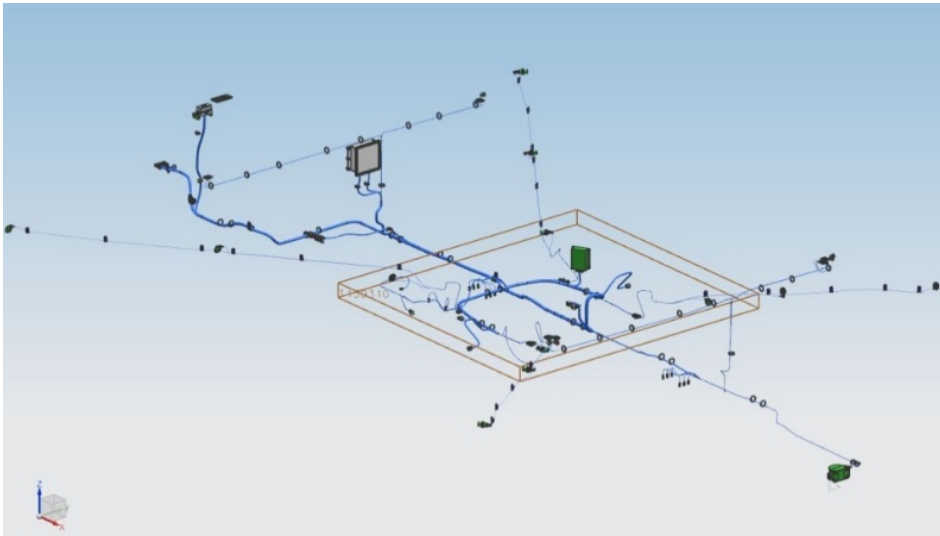

# Summary

**Project Name:** Electrical harnesses 3D Routing

**Scope:** Electrical system designing done for Excavator in Inventor

**Software:** Inventor

- Excavator electrical system done in inventor
- Harness drawing created in spite of ambiguity in the electrical inputs
- Clamping and dressing items finalized before protobuild based on outer diameter

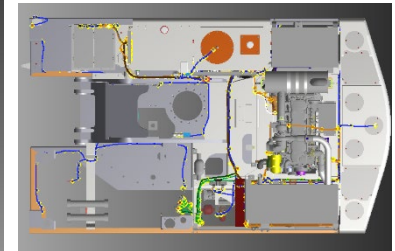
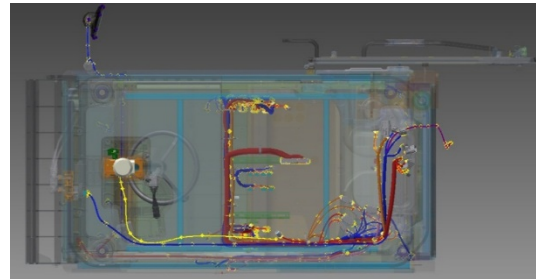
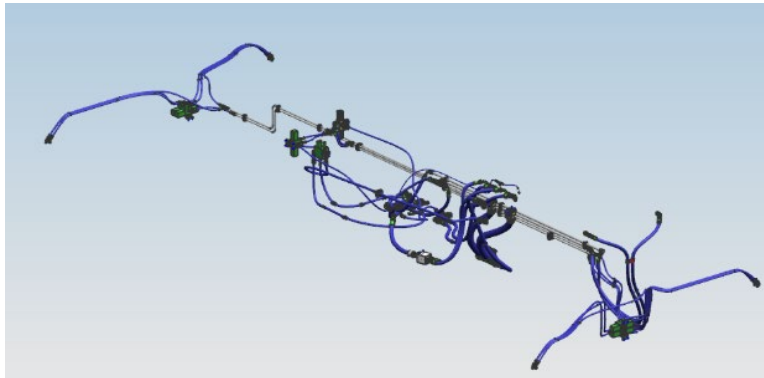
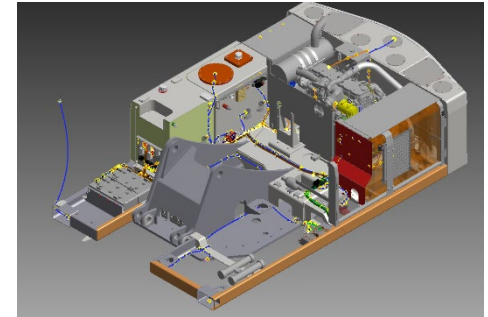
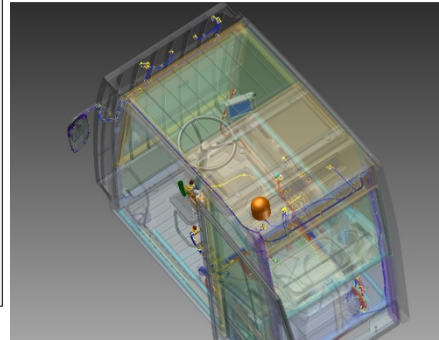

# Summary

**Project Name:** Dumper Electrical harnesses 3D Routing

**Scope:** Electrical System designing for Dumper

**Software:** Pro-E Creo 2.0

- 3D routing in Creo 2.0 provides accurate harness length for manufacturability
- Hazardous areas and bends taken care
- Clamps provided at right places
- Optimized wire length
- Assembly friendly layout generated

