



AUGER TOOLING FOR FOUNDATION AND UTILITY COMPANIES



WORKS FOR YOU.™

About Us

Terex® Works for You™ by listening, responding and delivering innovative solutions. Terex Utilities works to understand your challenges and earn your trust. The Terex team is committed to delivering reliable equipment, innovative technology, quality service as well as parts and auger tooling. The company continues to be the leader in technology and innovation in the utility industry.



WORKS FOR YOU.™

Experience & Products you can trust

For over 60 years, Terex has been designing and manufacturing quality rock drills, dirt augers and auger tooling products serving the utility, construction & foundation industries worldwide. Terex is one of a select few companies that design & build both drills and auger tooling.

- Experience in projects around the world provides us a unique understanding of what it takes to get the job done even in some of the most extreme conditions.
- Our business philosophy is to utilize our expertise to partner with our customers to truly understand their needs and provide solutions with products of the highest quality.
- New products and services are constantly being offered to help keep our customers updated with the latest in product improvements that enhance productivity and component life.

Service & Support you can count on

We are committed to serving and supporting our customers. Recognizing the demands customers face with tight schedules, emergency situations to get electricity on again, and other unexpected requirements, we stock a large inventory of finished auger tool products for fast delivery. Custom tooling products can be designed and built to meet special job applications.

Our Warranty

Terex offers a **1-year warranty** on material and workmanship of all our augers. Our warranty program is the best in the industry. We offer a 30-day return policy. If for any reason you don't like the tool, it can be returned.

Product specifications and prices are subject to change without notice or obligation. The photographs and / or drawings in this document are for illustrative purposes only. Refer to the appropriate Operator's Manual for instructions on the proper use of this equipment. Failure to follow the appropriate Operator's Manual when using our equipment may result in serious injury or death. The only warranty applicable to our equipment is the standard written warranty applicable to the particular product and sale and Terex makes no other warranty, express or implied. Products and services listed may be trademarks, service marks or trade-names of Terex Corporation and / or its subsidiaries in the USA and other countries. ©2020 Terex Corporation, Terex, Terex Crown Logo Design, and Works for You are trademarks of Terex Corporation or its subsidiaries. All other trademarks are property of their respective owners.



WORKS FOR YOU.™

Table of Contents

Augers

TXD (Dirt) Series	6
TXC (Carbide) Series	7
TXCS (Rock) Series	8
TRA (Rock) Series	10
BTA (Bullet) Series	11
BTA (Bullet) / Spiral Series	12
Interchangeable Auger	
Interchangeable Head Auger (ICH)	14
ICH TX Series (TXICH)	15
ICH Bullet Head (BTAICH) Series	16
ICH Bullet Head Spiral (BTASPICH)	17
Standalone Core Barrel Extendable Pilot	19
Clean-out/Drill Buckets	22

Accessories

Screw Anchor Adapters	23
Shank Plates TX Series	24
Shank Plates, TXCS Series	25
Hex Hubs / Adapters / Couplers	26
Kelly Bar Extension	27
Extension/ Screw Anchor Drive tool	28
Standard Pilot Bits & Adapters	29
Optional Pilot Bits & Adapters	30

Teeth and Blocks

TX Series	31
Blade Series	32
Bullet, .76", TC10 Series	33
Bullet, .74", TC20 Series	35
Bullet, .86", TC87 Series	36
Backyard Auger	38
Skidsteer Auger	39

Foundation Auger & Teeth

Bullet Tooth Rock Auger (BTR)	41
Spiral Bullet Tooth Auger (BTRSP)	42
Step/Blade Auger	43
Dirt Auger	44
Spin Bottom Barrel	45
Dump Bottom Barrel	46
Core Barrel	47
Kelly Box & Kelly Box Shims	48
Kelly Bar Adapters	49
Kelly Bar Extensions	50
Standard & Optional Pilot Bits	51
Collars & Pins	55

Teeth and Blocks

Blade Series	56
Taper-fit Series	57
Bullet, .76 Diameter, TC10 Series	58
Bullet, .74 Diameter, TC20 Series	60
Bullet, .86 Diameter, TC87 Series	61
Bullet, 1" Diameter, TC30 Series	62
Bullet, Step, TC4 Series	63
Core Barrel Teeth and Blocks	64
Tooth Removal/Installation Tpp;s	65

Tech Tips

Bullet Tooth Removal & Installation	66
Taper-Fit Series Removal & Installation	72
TX Series Tooth Removal & Installation	77

Product specifications and prices are subject to change without notice or obligation. The photographs and / or drawings in this document are for illustrative purposes only. Refer to the appropriate Operator's Manual for instructions on the proper use of this equipment. Failure to follow the appropriate Operator's Manual when using our equipment may result in serious injury or death. The only warranty applicable to our equipment is the standard written warranty applicable to the particular product and sale and Terex makes no other warranty, express or implied. Products and services listed may be trademarks, service marks or trade-names of Terex Corporation and / or its subsidiaries in the USA and other countries. ©2020 Terex Corporation, Terex, Terex Crown Logo Design, and Works for You are trademarks of Terex Corporation or its subsidiaries. All other trademarks are property of their respective owners.



TEREX®

WORKS FOR YOU.™

Digger Derrick Augers & Teeth

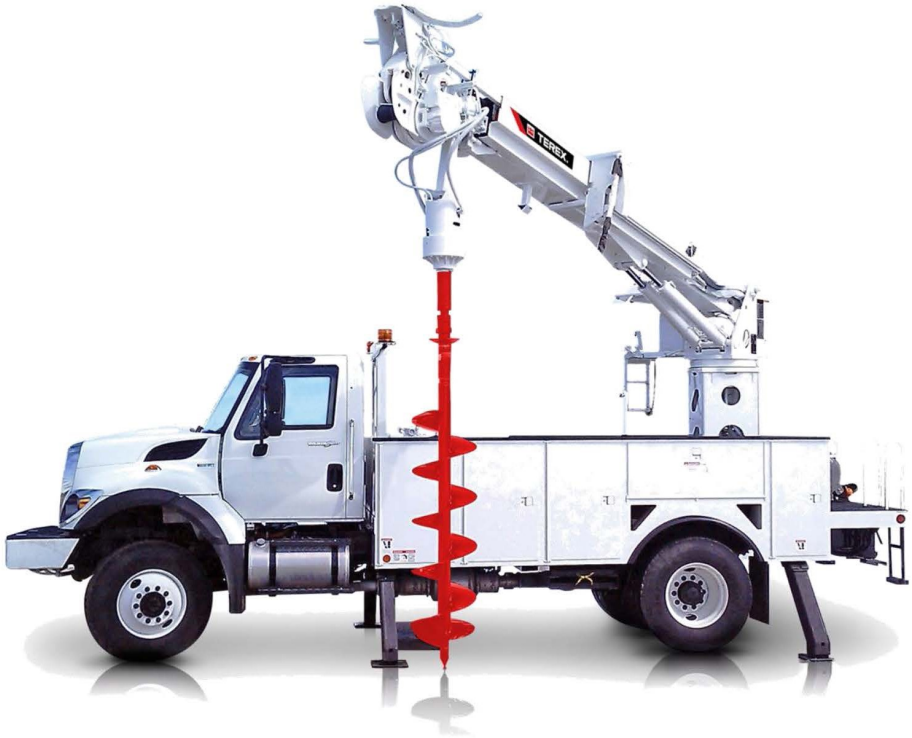

WORKS FOR YOU.™

TXD (Dirt)

Specifications:

This series of Augers has bolt on shank plate design. Standard flighting on Terex® TXD Series digger derrick augers are as follows:

- 2", 2-1/2", 2-5/8" or 3" Hex Hub available.
- 5/16" thick for 30" diameter and smaller.
- 1/2" thick for diameter larger than 30"

Standard components are as follows:

Teeth

TX50 (P#T29171)

TX52 (P#T29429)

Pilot

TX205 (P#T29168)

Application:

Terex® TXD Series digger derrick dirt augers are manufactured to improve the drilling performance of digger derricks, for loose and compacted soils, stiff clays and soft shale. The optional TX50D (P#T29167; See page 24) pilot bit greatly increases the performance of the TXD auger.

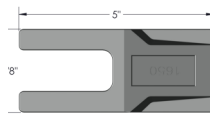

T29171

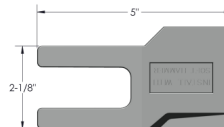

T29429



T29168

Diameter	Part number
9"	65355790
10"	65355796
12"	65355803
14"	65355811
16"	65355819
18"	65355828
20"	65355837
22"	65355854
24"	65355860
30"	65355871
36"	65355878
42"	65355885
48"	65355483
Other configurations available upon request.	

TXC (Carbide)

Specifications:

This series of Augers has bolt on shank plate design. Standard flighting on Terex® TXC Series digger derrick augers are as follows:

- 2", 2-1/2", 2-5/8" or 3" Hex Hub available.
- 5/16" thick for 30" diameter and smaller.
- 1/2" thick for diameter larger than 30"

Standard components are as follows:

Teeth

TX56 (P#TA029225)

TX52 (P#TA029400)

Pilot

TX205C (P#T29665)

Application:

Terex® TXC Series digger derrick carbide augers are manufactured to improve the drilling performance of digger derricks, for loose and compacted soils, stiff clays, shale, cobbles, and medium rock strata. The optional TX50c (P#T85889; See page 24) pilot bit greatly increases the performance of the TXC auger.



TA029925

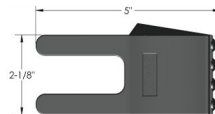

TA029400



T29665

Diameter	Part number
10"	65355575
12"	65355580
14"	65355585
16"	65355593
18"	65355604
20"	65355621
22"	65355708
24"	65355719
30"	65355741
36"	65355758
42"	65355765
48"	65355479

Other configurations available upon request.



WORKS FOR YOU.™

TXCS (Rock)

Specifications:

This series of Augers has bolt on shank plate design. Standard flighting on Terex® TXCS Series digger derrick augers are as follows:

- 2", 2-1/2", 2-5/8" or 3" Hex Hub available.
- 5/16" thick carry flighting.

Standard components are as follows:

Teeth

TX87 (P#65356898)

Pilot

C6-1/2-87 (P#T29936)

Application:

Terex® TXCS Series digger derrick rock augers are manufactured to improve the drilling performance of digger derricks, in limestone, medium sandstone, frozen materials, and medium to hard formations.

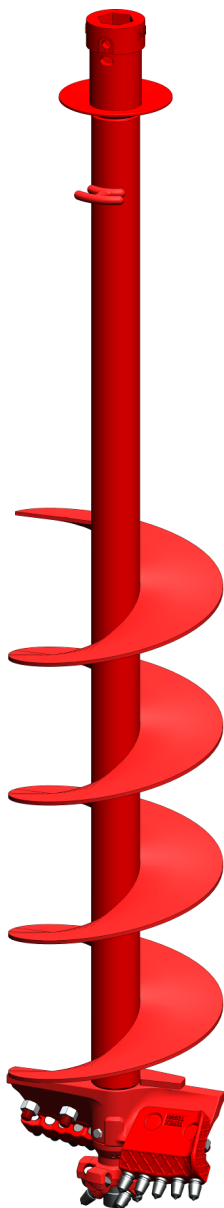

65356898

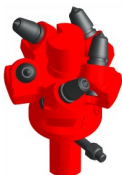

T29936

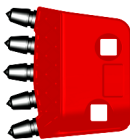

Bullet Shank Plate

Diameter	Part number
16"	65355772
18"	65355775
20"	65355781
24"	65355786
Other configurations available upon request.	



WORKS FOR YOU.™

TRA (Blade)

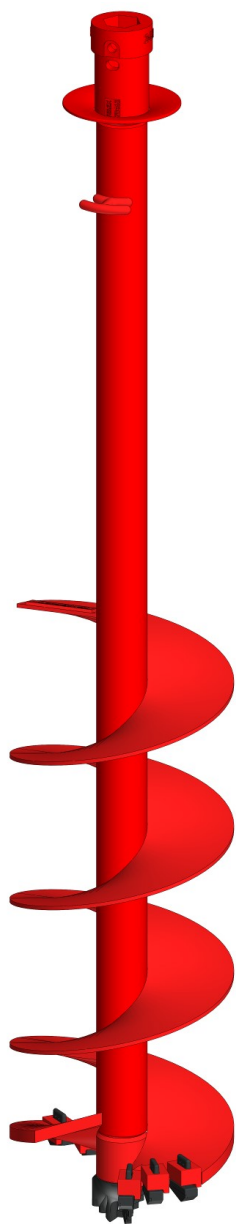

Specifications:

Standard flighting on Terex® TRA Series digger derrick augers have a 1" lower flight section, hard faced, combines with upper flighting as follows:

- 2", 2-1/2", 2-5/8" or 3" Hex Hub available.
- 5/16" thick for 30" diameter and smaller.
- 1/2" thick for 30" diameter larger than 30"

Standard components are as follows:

Teeth

TRT1 (P# T16844)

TWT2 (P# TA510184)

Pilot

TPB-6 (P# T16845)

Application:

Terex® TRA Series digger derrick rock augers are manufactured to improve the drilling performance of digger derricks, in hard rock formations, solid (non-fractural) formations in medium to hard drilling conditions.

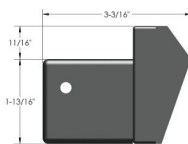

T16844

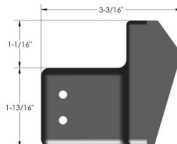

TA510184

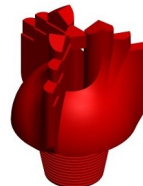

T16845

Diameter	Part number
9"	65355939
10"	65355942
12"	65355945
14"	65355948
16"	65355951
18"	65355954
20"	65355957
24"	65355960
30"	65355963
36"	65355966
42"	65355969

Other configurations available upon request.

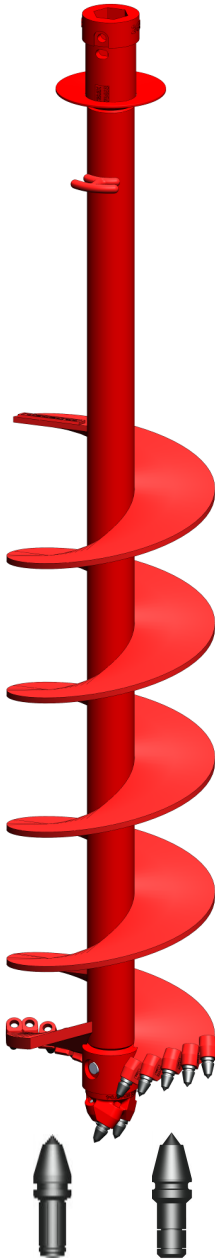

65349085 / 65349086 / 65345795

Specifications:

Terex® Bullet tooth auger (BTA) is manufactured with 1" lower flighting and 1/2" upper flight. 5/16" optional upper flighting. Drills hard materials that conventional augers cannot.

Standard components are as follows:

- 2", 2-1/2", 2-5/8" or 3" Hex Hub available.
- Teeth
C10 RC1LR-SN (P# 65349086)
- Pilot
TPB1 (P# 65345795; 65349085 pilot teeth)

Application:

The Terex® Bullet Tooth Auger (BTA) is designed specifically to improve the drilling performance of digger derrick augers in hard, fractural material such as limestone, lava, backfill material as well as cobbles and boulder type drilling conditions.

The Terex® Bullet Tooth Auger (BTA) have a unique cutting pattern that allows each tooth to cut a small track which increases cutting efficiency and tooth life. Our cut pattern and tooth attack angle combine to allow the bullet teeth to act as "fingers" that penetrate through and lift up fractured or broken material. This tool works with the digger derrick core barrel with extendable pilot bit option to improve functionality & increase productivity. *(See core barrel options on page 14)*

Diameter	Part number
10"	65355895
12"	65355898
14"	65355901
16"	65355904
18"	65355907
20"	65355910
22"	65355913
24"	65355916
30"	65355919
36"	65355922
42"	65355925
48"	65355486
Other configurations available upon request.	

BTA (Bullet)/Spiral (BTASP)

Specifications:

Terex® Bullet tooth spiral auger (BTASP) is manufactured with 1" lower flighting and 1/2" upper flight. 5/16" optional upper flighting. Drills hard materials that conventional augers cannot.

Standard components are as follows:

- 2", 2-1/2", 2-5/8" or 3" Hex Hub available.
- Teeth
C10 RC1LR-SN (P# 65349086)
- Pilot
TPB1 (P# 65357524; 65349085 pilot teeth)

Application:

The Terex® Bullet tooth spiral auger (BTASP) is designed specifically to improve the drilling performance of digger derricks in extreme conditions. This auger has a unique cutting pattern that allows each tooth to cut a small track to increase cutting efficiency and tooth life. The cut pattern and tooth attack angle combine to allow the bullet teeth to act as "fingers" that penetrate through and lift up fractured or broken material. In many cases, a digger derrick equipped with a spiral BTA can drill in conditions previously requiring a pressure digger. This tool works with the digger derrick core barrel with extendable pilot bit option to improve functionality & increase productivity. (See core barrel options on page 14)

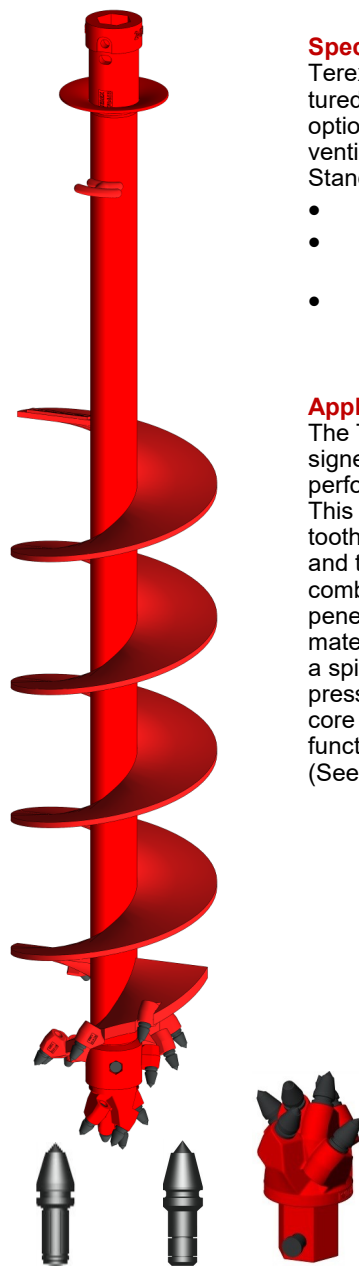

65349085 / 65349086 / 65357524

Diameter	Part number
9"	65345764
10"	65370316
12"	65367666
14"	65356037
16"	65356038
18"	65355927
20"	65355929
22"	65353892
24"	65355932
36"	65367611
30"	65355934
36"	65355936
Other configurations available upon request.	



TEREX®

WORKS FOR YOU.™

Interchangeable Head Auger (ICH)

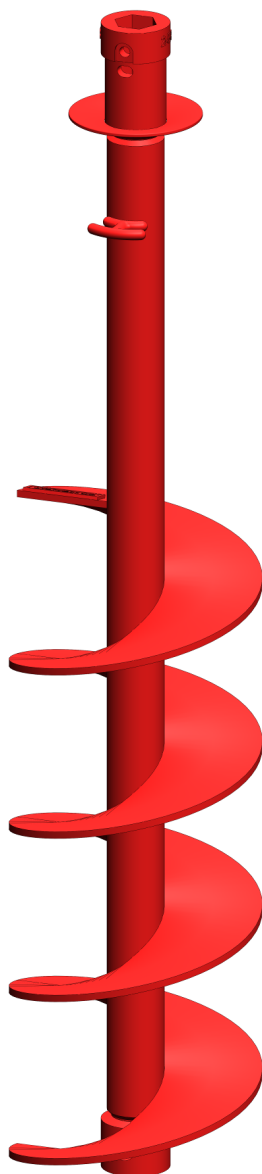

Specifications:

Terex® Interchangeable head auger body is manufactured with options of the following:

- 2", 2-1/2", 2-5/8" or 3" Hex Hub available.
- Medium duty (5/16" flight)
- Heavy duty (1/2" flight)
- Extra Heavy duty (3/4" flight)

Application:

The Terex® Interchangeable head auger designed specifically to improve the drilling performance of digger derricks where multiple types of augers are needed.

This tool works with the digger derrick core barrel with extendable pilot bit option to improve functionality and increase productivity. (See core barrel options on page 14)

Medium Duty	
Diameter	Part number
18	65357480
20	65357470
22	65357481
24	65357482
Heavy Duty	
Diameter	Part number
18	65357483
20	65357485
22	65357487
24	65357488
36	65357489
Extra Heavy Duty	
Diameter	Part number
18	65357491
20	65357493
22	65357495
2", 2-1/2", 2-5/8" & 3" Hex available upon request.	
Other configurations available upon request.	

Interchangeable TX Series (TXICH)

Specifications:

This series of Augers has bolt on shank plate design. Standard flighting on Terex® Interchangeable TX series (TXICH) are as follows:

5/16" thick for 30" diameter and smaller.

1/2" thick for diameter larger than 30"

Standard components are as follows:

TXD

TX50 (P#T29171) dirt teeth.

TX52 (P#T29429) dirt teeth.

TX205 (P#T29168) pilot bit.

TXC

TX56 (P#TA029225) carbide teeth.

TX52 (P#TA029400) carbide teeth

TX205C (P#T29665) pilot bit.

TXCS

TX87 (P#65356898) bullet teeth.

C6-1/2-87 (P#T29936) pilot bit.

Application:

Terex® TXD Series digger derrick dirt augers are manufactured to improve the drilling performance of digger derricks, for loose and compacted soils, stiff clays and soft shale. The optional TX50D (P#T29167) pilot bit greatly increases the performance of the TXD auger.

Terex® TXC Series digger derrick carbide augers are manufactured to improve the drilling performance of digger derricks, for loose and compacted soils, stiff clays, shale, cobbles, and medium rock strata. The optional TX50C (P#T85889) pilot bit greatly increases the performance of the TXC auger.

Terex® TXCS Series digger derrick rock augers are manufactured to improve the drilling performance of digger derricks, in limestone, medium sandstone, frozen materials, and medium to hard formations.

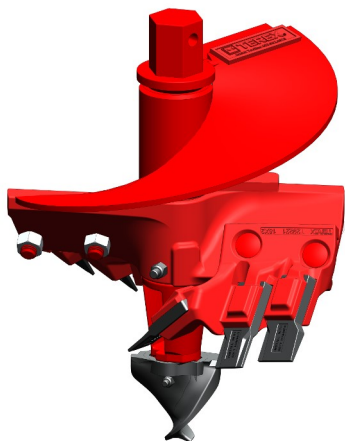

Diameter	Part number
TXD	
18"	65353803
20"	65353804
22"	65354120
24"	65353805
TXC	
18"	65352115
20"	65351943
22"	65354119
24"	65353802
26"	65357500
32"	65357502
TXCS	
18"	65357578
Other configurations available upon request.	



WORKS FOR YOU.™

Interchangeable Bullet Head (BTAICH)

Specifications:

Terex® Interchangeable Bullet Tooth (BTAICH) is manufactured with 1" flighting. Drills hard materials that conventional augers cannot.

Standard components are as follows:

Teeth

C10 RC1LR-SN (P# 65349085)

Pilot

TPB1 (P# 65345795)

Application:

The Terex® Interchangeable Bullet Tooth (BTAICH) is designed specifically to improve the drilling performance of digger derrick augers in hard, fractural material such as limestone, lava, backfill material as well as cobbles and boulder type drilling conditions.

The Terex® Interchangeable Bullet Tooth (BTAICH) have a unique cutting pattern that allows each tooth to cut a small track which increases cutting efficiency and tooth life. Our cut pattern and tooth attack angle combine to allow the bullet teeth to act as "fingers" that penetrate through and lift up fractured or broken material.

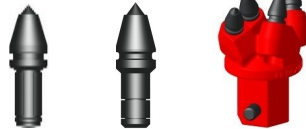
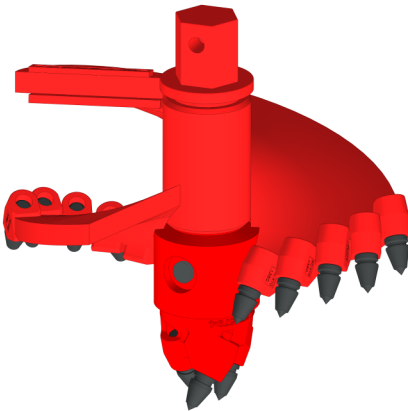

65349085/65349086/65345795

Diameter	Part number
18"	65352111
20"	65351958
22"	65354115
24"	65353799
Other configurations available upon request.	



TEREX®

WORKS FOR YOU.™

Interchangeable Bullet Head Spiral (BTASPICH)

Specifications:

Terex® Interchangeable Bullet Head Spiral (BTASPICH) is manufactured with 1" lower flighting and 1/2" upper flight. 5/16" optional upper flighting. Drills hard materials that conventional augers cannot. Standard components are as follows:

- Teeth C10 RC1LR-SN (P# 65349085)
- Pilot C10-6T-SP (P# 65357524)

Application:

The Terex® Interchangeable Bullet Head Spiral (BTASPICH) is designed specifically to improve the drilling performance of digger derrick augers in extreme conditions. This auger has a unique cutting pattern that allows each tooth to cut a small track to increase cutting efficiency and tooth life. The cut pattern and tooth attack angle combine to allow the bullet teeth to act as “fingers” that penetrate through and lift up fractured or broken material. In many cases a digger derrick equipped with a BTA spiral auger can drill in conditions previously requiring a pressure digger.

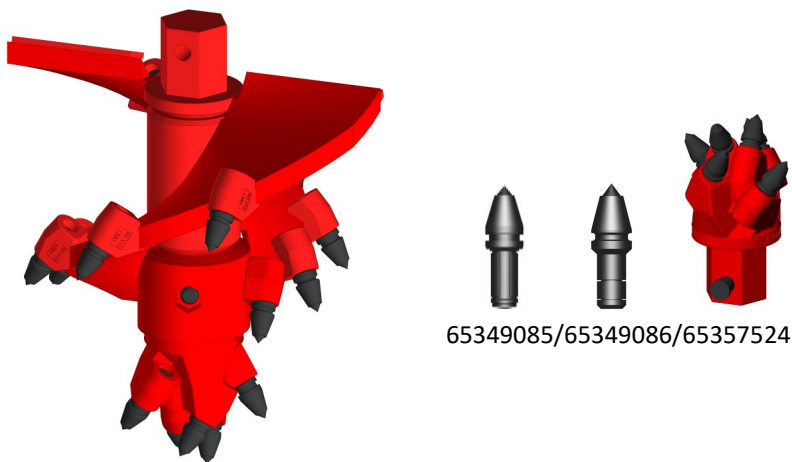

Diameter	Part number
18"	65352112
20"	65351945
22"	65354117
24"	65353801
36"	65352066
Other configurations available upon request.	



WORKS FOR YOU.™



Standalone Core Barrel/Extendable Pilot

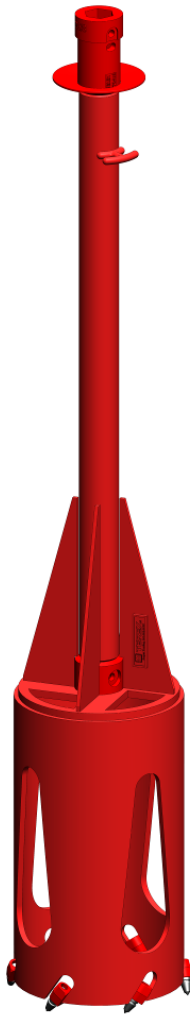

Features:

Terex® digger derrick Standalone core barrel, extendable pilot bit. Are available in a range of diameters.

Standard specification are as follows:

- 2", 2-1/2", 2-5/8" or 3" Hex Hub available.
- 5/8" wall thickness.
- 30" barrel length.
- 5-tooth cut pattern.
- Available with bullet teeth, J-tooth, or hex tooth configuration.
- Relief slots around barrel circumference.
- Relief cuts in top for reduced crowd pressure.

Application:

Coring of fractural and non-fractural rock, non-reinforced and reinforced concrete. For use when material cannot be effectively drilled with conventional digger derrick augers. The optional extendable pilot used with the barrel allows for an easy start and provides additional stability in extremely hard rock or out of level surfaces.



65343343
(Sold separately)

Diameter	Part number
18"	65367631
20"	65367670
22"	65367719
24"	65367674
Other configurations available upon request.	



TEREX®

WORKS FOR YOU.™



View the Core Barre in action at:

https://www.youtube.com/watch?v=1KLRI_KfF2k&feature=youtu.be



WORKS FOR YOU.™



Clean-out/Drill Buckets

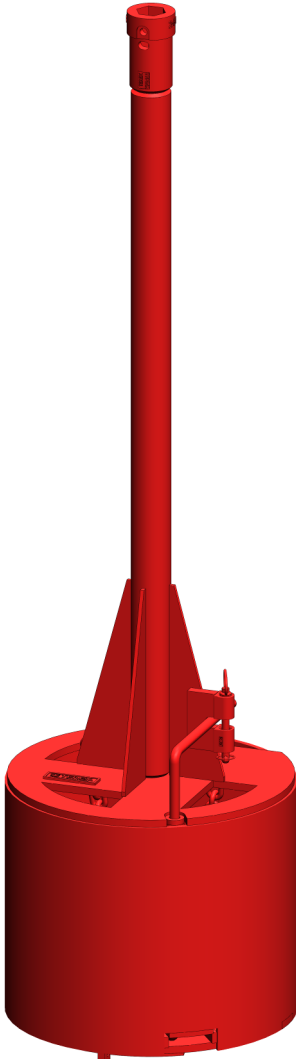

Features:

Terex® digger derrick clean-out/drill buckets Are available in a range of diameters and types. Standard specifications are as follows:

- 2", 2-1/2", 2-5/8" or 3" Hex Hub available.
- 5/8" wall thickness.
- 30" barrel length.
- Choice of 3/4" x 3" steel scraper blade; teeth and/or pilot bits.
- Relief cuts in top for reduced crowd pressure.

Application:

Spin-Bottom Clean-out

Used to remove fluid type (mud) material from drilled shaft when material does not adhere to auger flighting.

Spin-Bottom/Drill

Used for drilling loose sandy soil, small cobble stones and mud conditions when material does not adhere to auger flighting.

Dump-Bottom Clean-out

Used to remove fluid type (mud) material from drilled shaft when material does not adhere to auger flighting.

Manual or auto dump mechanism options available.

Dump-Bottom/Drill

Used for drilling loose sandy soil, small cobble stones and mud conditions when material does not adhere to auger flighting. Manual or auto dump mechanism options available.



TEREX®

WORKS FOR YOU.™

Screw Anchor Adapters

Power Installed Screw Anchor (PISA)

Application:

Adapts (AB Chance) power installed screw anchor (PISA) tools to drive hex on pilot end of Terex BTA(SP) or ICH Augers.

Allows installation of PISA adapter without removing auger from Kelly bar.

Simply pin PISA tool into hex pilot socket on bottom of auger.

Tool adapts from 2-5/8" hex to AB Chance bolt pattern.

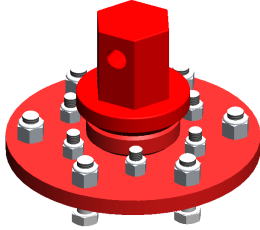

Description	Part number
6HOLE 5-1/2" - 10,000 FT/LB; 12HOLE 7-5/8" - 15,000 FT/LB	65375787

Over Pilot Screw Anchor Adapter

Application:

Adapts (TX pilot bits) to over pilot screw anchor tools to drive screw anchors into the ground.

Allows installation of adapter without removing auger from Kelly bar. Simply pin Tool over TX pilot on bottom of auger.



Description	Part number
Screw Anchor Adapter	65370407

Screw Anchor Pilot Adapter

Application:

Adapts pilot bit onto end of auger to drive screw anchors into the ground. Allows installation of adapter without removing auger from Kelly bar. Simply remove existing pilot bit from auger and pin tool into boring head on bottom of auger.

Description	Part number
Pilot, Screw Anchor Adapter	65374314

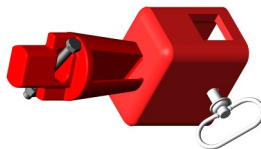

Shank Plates TX Series



T29301 T29302 T29224 T29189 T29190 T29220 T29221



T29191 T29192 T29193 T29194 65348648 65348658



T29199 T29248 T29249 T29250



65340693 65340697



BOLT 7/8-9UNCX3 GR8
P/N - T81517



NUT 7/8-9 GR8
P/N - T81518

Part number	Description	Diameter	Teeth Qty	Part number	Description	Diameter	Teeth Qty
T29301	TX810X	8/10	1	T29194	TX24X2	24	4
T29302	TX12X	12	2	65348648	TX26/27X1	26/27	4
T29224	TX145X	14	2	65348658	TX26/27X2	26/27	4
T29189	TX16X1	16	2	T29199	TX30X1	30	4
T29190	TX16X2	16	2	T29248	TX30X2	30	4
T29220	TX18X1	18	3	T29249	TX36X1	36	4
T29221	TX18X2	18	3	T29250	TX36X2	36	4
T29191	TX20/22X1	20/22	3	65340693	TX42X1	42	6
T29192	TX20/22X2	20/22	3	65340697	TX48X1	48	7
T29193	TX24X1	24	3				



TEREX®

WORKS FOR YOU.™

Shank Plates TXCS Series



T29960

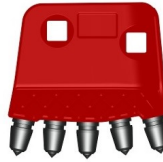

T29961



T29962



T29965



BOLT 7/8-9UNCX3 GR8
P/N - T81517



NUT 7/8-9 GR8
P/N - T81518

Part number	Description	Diameter	Teeth Quantity
T29960	C-016 Plate with C87 Teeth	16	4
T29961	C-018 Plate with C87 Teeth	18	5
T29962	C-020 Plate with C87 Teeth	20	5
T29965	C-024-3 Plate with C87 Teeth	24	6



TEREX®

WORKS FOR YOU.™

Hex Hubs / Adapters / Couplers

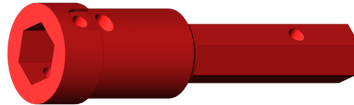
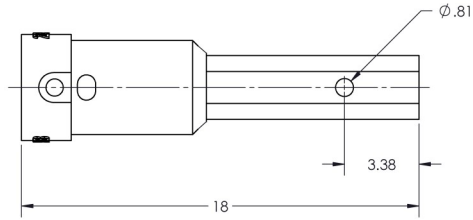

Part Number	Hex Hub Size	Part Number	Description
TA000748	2.00	TA001113	2.00"HEX x 2.50"BAR
T29641	2.50	TA000100	2.50"HEX x 2.00"BAR
T70463	2.62	TA000853	2.50"HEX x 2.62"BAR
TA000474	3.00	TA000099	2.62"HEX x 2.00"BAR
		TA000561	2.62"HEX x 2.50"BAR
		TA001980	3.00"HEX x 2.50"BAR
Other configurations available upon request.			

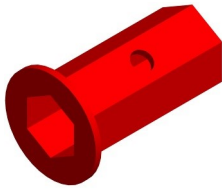

Style	Part Number	Description
S	45142	ASSY, 2" X 2" SLIP ON
S	437927	ASSY, 2" X 2-5/8" SLIP ON
I	11448	BUSHING 2" X 2-5/8"
C	9127787	ASSY, 2" X 2.50" CLAMP ON
C	9119389	2-1/2" X 2-1/2" CLAMP ON
S	431390	ASSY, 2-1/2" X 2-5/8" SLIP ON
S	45143	ASSY, 2-5/8" X 2-5/8" SLIP ON
Assemblies include retainer ring and hardware.		



TEREX®

WORKS FOR YOU.™

Kelly Bar Extension

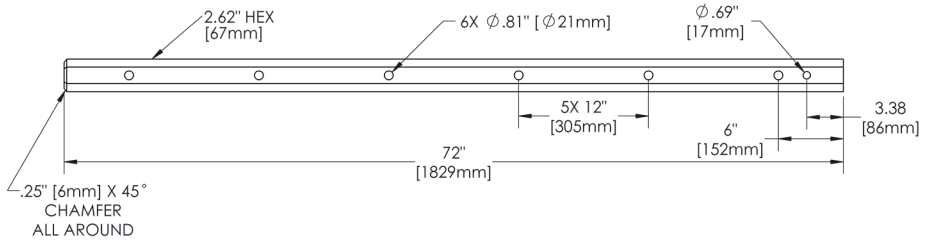

Part number	Bar size	Length
*11579	2.00	60.00
T80597	2.00	72.00
*9122145	2.50	60.00
T80598	2.50	72.00
**T54911	2.62	60.00
65357478	2.62	60.00
T80599	2.62	72.00
Other configurations available upon request		

* These Kelly Bars are heat treated alloy steel for high torque applications and are factory install on all Terex Digger Derricks.

** 54911TU for MKIII & 2-Speed Eskridge models



Part number	Hub	Bar	Length	Max torque	
				Ft-lb	nm
T80600	2.00	2.00	72	6,000	8126
T82154	2.50	2.00	72	6,000	8126
T84698	2.00	2.50	72	12,000	16251
T71579	2.50	2.50	72	12,000	16251
65343450	2.50	2.50	60	12,000	16251
T80601	2.50	2.62	72	14,000	19040
T81388	2.62	2.50	72	12,000	16251
65347717	2.62	2.62	36	14,000	19040
65345762	2.62	2.62	60	14,000	19040
T80602	2.62	2.62	72	14,000	19040
Other configurations available upon request					



TEREX®

WORKS FOR YOU.™

Hollow Kelly Bar / Screw Anchor Drive Tool



Application:

Hollow kelly bar with spring loaded cam action locking dogs allow it to be used as both an auger extension shaft and a screw anchor drive. This allows the screw anchor rod to be inserted directly into the kelly bar and eliminates the need for a screw anchor adapter.

Available with welded couplers upon request.

- Eliminates lifting and handling of heavy screw anchor adapters
- Allows quicker screw anchor setup time

Part number	Description	Hub	Bar
445231	1.62 dia hole thru (2.16 OD x 1.46 ID sq tube for driving anchors) For 1.38" screw drive	2.00	2.62
402331	1.62 dia hole thru (2.16 OD x 1.46 ID sq tube for driving anchors) For 1.38" screw drive	2.50	2.62
402330	1.62 dia hole thru (2.16 OD x 1.46 ID sq tube for driving anchors) For 1.38" screw drive	2.62	2.62
470331	1.62 dia hole thru (2.16 OD x 1.54 ID sq tube for driving anchors) For 1.50" screw anchors	2.62	2.62



TEREX®

WORKS FOR YOU.™

Standard Pilot Bits & Adapters



T29665



T29200



T29936

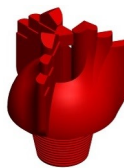

T16845

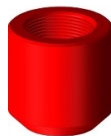

T80342



65345795



65357524



65343434

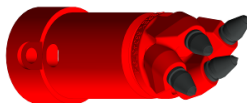

65345810

Part number	Code	Description
T29168	TX205D	Standard pilot on TXD series augers. Dirt, compacted soil, clay material. Includes hardware PN 36026 & 15506.
T29665	TX205C	Standard pilot on TXC series augers. For fractured & non-fracturable material, Includes hardware PN 36026 & 15506.
T29200	TX183	Pilot bit adapter, TX183, cast steel (standard with TX205C & TX205D) Includes hardware T42675 & T5973.
T29936	C6 1/2 87 C387LR	Standard on TXCS series augers. Five replaceable C87 teeth (T29914). Includes hardware PN T42675 & T5973.
T16845	TPB6	Standard on TRA/STEP/BLADE series augers. 4-3/4" cut diameter 2-3/8" API.
T80342	Collar	Use with T80342 sub. Sub, pilot, 4" diameter, 2-3/8" API
65345795	TPB1-HEX	Standard for BTA series augers. 2-5/8" hex shank Four replaceable C10 teeth (65349085)
65357524	SPIRAL HEX	Use with 65343434 sub Standard for BTA spiral series augers. 2-5/8" hex shank Six replaceable teeth (65349085)
65343434	TBA-HEX	2-5/8 hex collar.
65345810	COR PILOT	Sub, 2-5/8" hex collar Standard for digger derrick core barrel series. 2-5/8" hex coupler Four replaceable C10 teeth (65349085)
Other configurations available upon request.		



TEREX®

WORKS FOR YOU.™

Optional Pilot Bits & Adapters



T29167



T85889



T70797C



TA017437



T29948



T29934



TA000142



65342191



T29894



65354183



65350998

Part number	Code	Description
T29167	TX50D	Cast steel, replaceable TX50 & TX52 hardened steel teeth (T29171 & T29429). For dirt, compacted soil, stiff clay, fracturable material & gravel application. 7-1/2" Cut diameter. Includes hardware PN T42675 & T5973.
T85889	TX50C	Cast steel, replaceable TX50 & TX52 hardened steel teeth (TA029225 & TA029400). For fractured & non-fracturable material, hard pan, frozen soil, cement, limestone & conglomerates application. 7-1/2" Cut diameter. Includes hardware PN T42675 & T5973.
T70797C	TPB1	Optional on BTA series augers. 2-5/8" API Threads Four replaceable C10 teeth (65349085) 5-1/4" cut diameter.
TA017437	TXBA9	Adapter, pilot bit. Bolts directly to boring head and allows use of all 2-5/8" API pin pilot bits. Includes hardware PN T42675 & T5973.
T29948	CP-16	Pilot bit, 2" cut with 1" NC thread
T29934	TXCP-18	Pilot bit, 2" cut with 1-1/4-5 Acme threads.
TA000142	CP-18 Collar	Pilot chuck, 1-1/4-5 STPE
65342191	TPB1-1-3/4"	BTA series augers Four replaceable C10 teeth (65349085) 1-3/4" square shank 5-1/4" cut diameter
T29894	TBA-175	Sub, 1.75" square collar
65354183	SPIRAL HEX	BTA series augers Six replaceable C30 teeth (TA001537) 2-5/8" hex shank 8-1/2" cut diameter Use with 65343434 sub
65350998	DIRT PILOT	BTA series augers Fishtail bit, 2-5/8" hex shank
Other configurations available upon request.		



TEREX®

WORKS FOR YOU.™

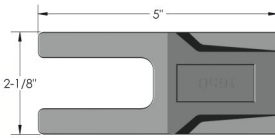

T29171
25 per bucket
1250 per pallet

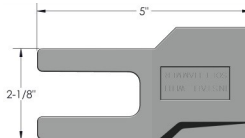

T29429
25 per bucket
1250 per pallet

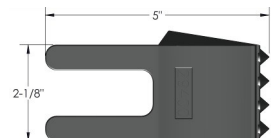

TA029225
25 per bucket
1250 per pallet

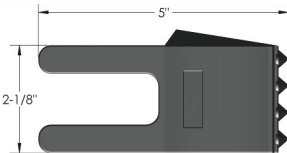

TA029400
25 per bucket
1250 per pallet

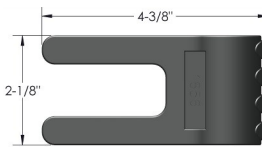

65342386
25 per bucket
1250 per pallet

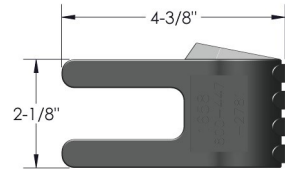

65342385
25 per bucket
1250 per pallet

Part number	Code	Application
T29171	TX50/1650	Dirt, compacted soils, low abrasion materials, fits all TX- series shank plates & TX-50 replaceable tooth pilot.
T29429	TX52/1652	Dirt, compacted soils, low abrasion materials, fits all TX-series shank plates & TX-50 replaceable tooth pilot. Recommended for outside blocks.
TA029225	TX56/1656	Fractured and non-fractured materials, frozen soils, abrasive materials. Conical tips increase penetration rates in most materials. Fits all TX-series shank plates & TX50C pilot.
TA029400	TX58/1658	Fractured and non-fractured materials, frozen soils, abrasive materials, conical tips increase penetration rates in most materials. Fits all TX-series shank plates & TX50C pilot. Recommended for outside blocks.
65342386	TX56CH	Non-fractured materials, frozen soils, abrasive materials. Tips increase penetration rates in most materials. Fits all TX-Series shank plates & TX50C pilot.
65342385	TX58CH	Non-fractured materials, frozen soils, abrasive materials. Tips increase penetration rates in most materials. Fits all TX-series shank plates & TX50C pilot. Recommended for outside blocks.



TEREX®

WORKS FOR YOU.™

Blade Series

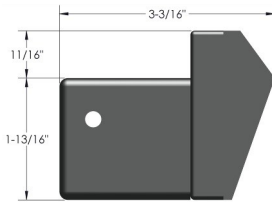

T16844
25 per bucket
1250 per pallet

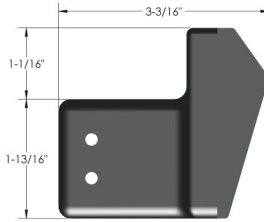

TA510184
25 per bucket
1250 per pallet

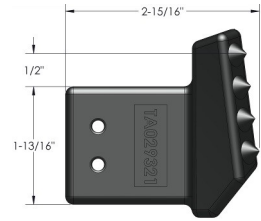

TA029321
25 per bucket
1250 per pallet

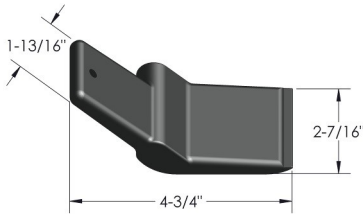

T17318
25 per bucket
1500 per pallet

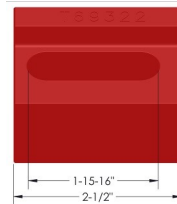

T69322
25 per bucket
1250 per pallet

Part Number	Code	Application
T16844	TRT1 TX	Non-fractured material, frozen soil, abrasive material. Medium to hard rock.
TA510184	TWT2 TX	Non-fractured material, frozen soil abrasive material. Medium to hard rock.
TA029321	TK55C KM	Fractured and non-fractured material. Angle of attack & conical tips increase penetration rates in most augerable materials. Hard to very hard rock.
T17318	TDB31/D7000 TX	Soft earth digging, and clay materials.
T69322	TAP3 TX	Accepts all above teeth. Welded with 7018 or 8018 low-hydrogen rod.

Bullet, .76, TC10 Series



TA001375
75 per bucket



TA001371
75 per bucket



TA001379
75 per bucket



T68888
75 per bucket



T29911
75 per bucket



TA001376
75 per bucket

Part number	Code	Application
TA001375	RB1LR SN KM	Small diameter tip reduces vibration during concrete cutting. Long retainer.
TA001371	RB3LR KM	Fractured and non-fractured materials, frozen soils, and abrasive materials. Long retainer.
TA001379	RB3SR KM	Fractured and non-fractured materials, frozen soils, and abrasive materials. Short retainer.
T29912	RL08/C3LR KM	Cutting concrete and other tough cutting applications. Long retainer.
T29913	RL09/C3SR94 KM	For cutting concrete and other tough cutting applications. Short retainer.
T68888	TX1HDLR KM	For drilling concrete and rock cutting. Double-angle tip provides maximum impact strength. Long retainer.
T29911	TX1HDSR KM	For drilling concrete and rock cutting. Double-angle tip provides maximum impact strength. Short retainer.
TA001376	RB1SR-SN KM	Fractured and non-fractured materials, frozen soils, and abrasive materials. Short retainer.
65342401	RL09 TX	For cutting concrete and other tough cutting applications. Ideal use for Spiral BTA series.
T70795	RL11 KM	For cutting soft to medium-hard materials with good penetration. Dimpled retainer for increased holding power in grooved blocks.



TEREX®

WORKS FOR YOU.™

Bullet, .76, TC10 Series



65349085
75 per bucket
3750 per pallet



65349086
75 per bucket
3750 per pallet



TA000897
75 per bucket
4500 per pallet



65350265
75 per bucket
3750 per pallet



TA001455
70 per bucket
3500 per pallet

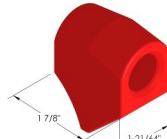

T29941
50 per bucket
2500 per pallet

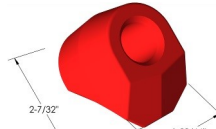

T29942
25 per bucket
1500 per pallet

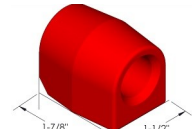

TA001404
50 per bucket
2500 per pallet

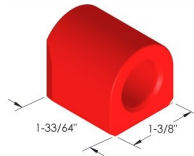

65350264
50 per bucket
2500 per pallet

Part number	Code	Application
65349085	RC1LR-SN TX	Small diameter tip reduces vibration during concrete cutting. Long retainer.
65349086	RC1SR-SN TX	Fractured and non-fractured materials, frozen soils, and abrasive materials. Short retainer.
TA000897	C1HDSR RL10 KM	For drilling concrete and rock cutting. Double-angle tip provides maximum impact strength. Short retainer.
65350265	RC1SR-SN TX	Fractured and non-fractured materials, frozen soils, and abrasive materials Short retainer.
TA001455	RS16 TX	For drilling concrete and rock cutting. Double-angle tip provides maximum impact strength. Short retainer.
T29941	C10 KM	45° mounting surface with a narrower face than C10HD style. Welded with 7018 or 8018 low-hydrogen rod.
T29942	C10HD KM	45° mounting surface. Extra-heavy-duty design. Welded with 7018 or 8018 low-hydrogen rod.
TA001404	RC10F TX	For buckets, barrels, and special applications. Welded with 7018 or 8018 low-hydrogen rod.
65350264	RC10FS TX	For buckets, barrels, and special applications. Welded with 7018 or 8018 low-hydrogen rod.



TEREX®

WORKS FOR YOU.™

Bullet, .74, TC20 Series



T29897
75 per bucket
3750 per pallet



65350253
75 per bucket
4500 per pallet



T29898
75 per bucket
3750 per pallet

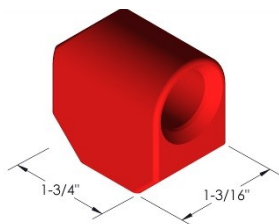

T29938
50 per bucket
3000 per pallet

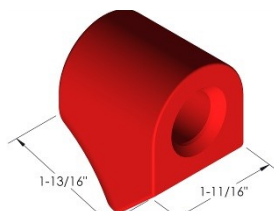

T29939
25 per bucket
1250 per pallet

Part Number	Code	Application
T29897	C21 KM	For most cutting applications. Especially good in soft to medium-hard material. Carbide tip (5/16" dia.) for fast penetration. Short Retainer.
65350253	RC21HD TX	Heavy duty design for extremely hard rock and concrete. Carbide tip (1/2" dia.) provides long tool life. Short Retainer.
T29898	C21HD KM	Heavy duty design for extremely hard rock and concrete. Carbide tip (1/2" dia.) provides long tool life. Short Retainer.
T29900	C23 TX	Drilling and core-barreling in soft to medium-hard rock with abrasive cutting conditions. Short Retainer.
65340029	C23 KM	Drilling and core-barreling in soft to medium-hard rock with abrasive cutting conditions. Short Retainer.
TA001373	RB23 KM	Soft to medium-hard rock with abrasive conditions. Short Retainer.
T29901	C24 KM	Drilling soft material. Sharp nose tip for high penetration. Short Retainer.
T29938	RC20 TX	45° mounting surface thinner width allows closer block placement in restricted areas. Welded with 7018 or 8018 low-hydrogen rod.
T29939	C20HD KM	45° mounting surface heavier block design than the C20 block. Welded with 7018 or 8018 low-hydrogen rod.



TEREX®

WORKS FOR YOU.™

Bullet, .86", TC87 Series



T29916
50 per bucket
2500 per pallet



T29917
50 per bucket
2500 per pallet

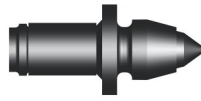

65356913
50 per bucket
2500 per pallet



T29914
60 per bucket
3000 per pallet



T29915
70 per bucket
3500 per pallet

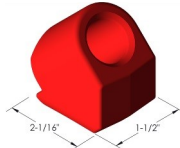

T29945
40 per bucket
2000 per pallet

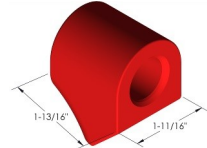

T29946
25 per bucket
1250 per pallet

Part Number	Code	Application
T29916	SM06 KM	For drilling hard rock or concrete. Double-angle tip for maximum impact strength.
T29917	SM02 KM	For asphalt or abrasive applications. Sharp tip for improved penetration.
65356913	SM02 TX	For asphalt or abrasive applications. Sharp tip for improved penetration.
T29914	TX87LR KM	Hard rock or concrete. Sharp tip for improved penetration.
T29915	C387LR KM	For asphalt or abrasive applications.
T29945	C87B KM	45° mounting surface heavy duty design (has machined step for non-rotating tools). Welded with 7018 or 8018 low-hydrogen rod.
T29946	C87HDS KM	45° mounting surface extra heavy duty design (has machined shoulder in bore to provide extended life. Welded with 7018 or 8018 low-hydrogen rod.



TEREX®

WORKS FOR YOU.™



65356802

65351046



65349080

Part Number	Code	Application
65356802	PIN-5/8"OD/6"L	For use on units with hollow kelly bar.
65351046	PIN-3/4"OD/6"L	For use on units with solid kelly bar.
65349080	PIN-1"OD/8-1/2"L	Use with 4" kelly box & smaller and 6" kelly box.

Backyard Auger

Specifications:

Terex® Backyard augers come in variety of size and types.
Typical Length is 66", other lengths available upon request.
2" hex or square hub.

3-1/2" diameter stem (1026 SRA); 5/16" Wall thickness

We offer our standard augers as a light duty option such as TX-Series, Bullet and Spiral type augers.

Application:

The Terex® TX series Backyard augers (dirt, carbide, rock) are manufactured to improve the drilling performance of Skidsteer or backyard auger unit's.

Dirt - Loose and compacted soils, stiff clays and soft shale.

Carbide - Loose and compacted soils, stiff clays, shale and cobbles; medium rock strata.

Rock - Limestone, medium sandstone and frozen materials; medium formations.

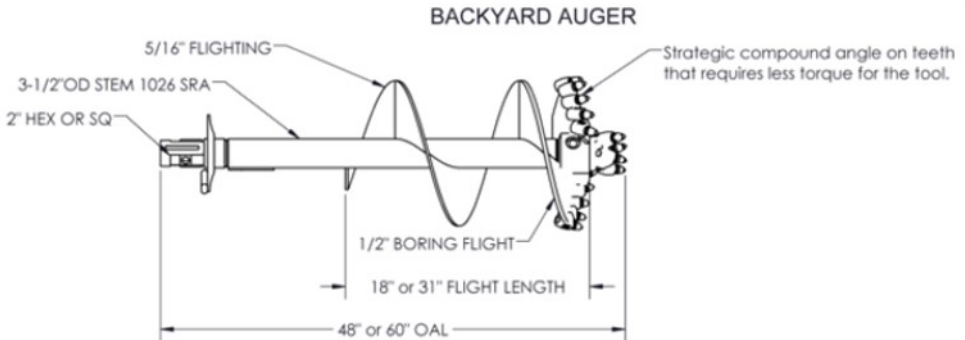

Skidsteer Auger

Specifications:

Terex® Skidsteer augers come in variety of size and types.
Typical Length is 66", other lengths available upon request.
2" hex or square hub.

3-1/2" diameter stem (1026 SRA); 5/16" Wall thickness

We offer our standard augers as a light duty option such as TX-Series, Bullet and Spiral type augers.

Application:

The Terex® TX series Skidsteer augers (dirt, carbide, rock) are manufactured to improve the drilling performance of Skidsteer or backyard auger unit's.

Dirt - Loose and compacted soils, stiff clays and soft shale.

Carbide - Loose and compacted soils, stiff clays, shale and cobbles; medium rock strata.

Rock - Limestone, medium sandstone and frozen materials; medium formations.

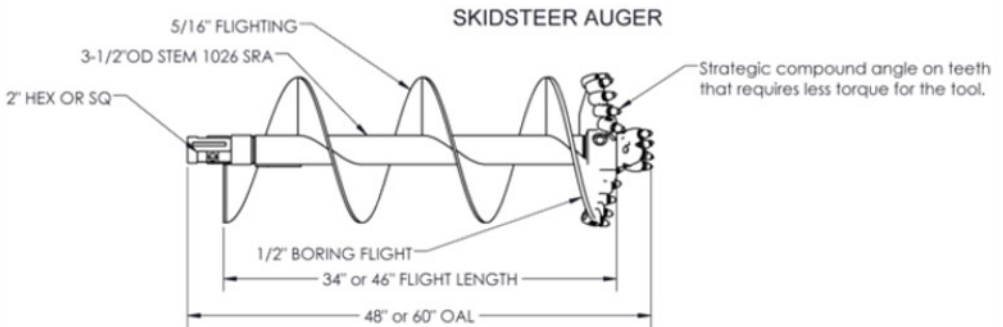

Foundation Augers & Teeth

***Terex is a one
stop shop for
all your auger
tooling
needs. No
matter what
type of
equipment
your are
running.***

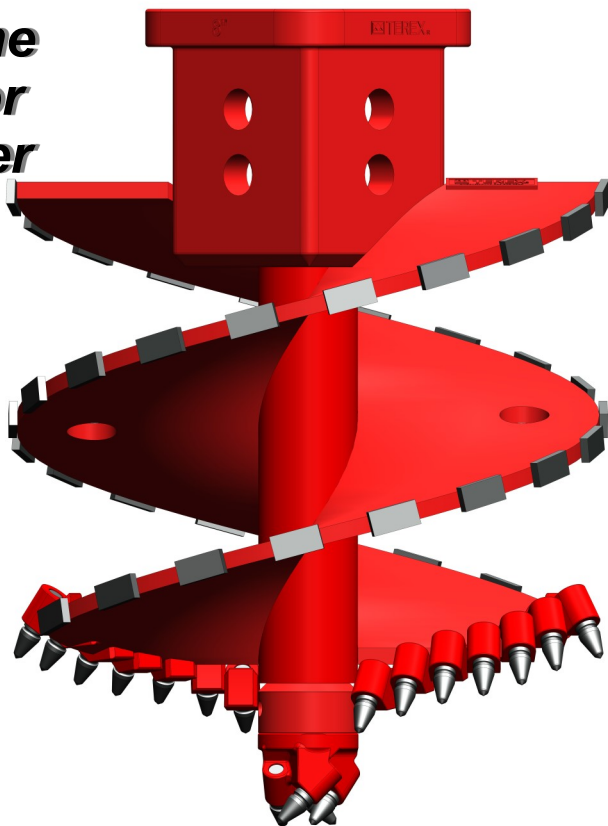

***Terex is an authorized administer of the NCCCO Foundation
Drill Rig Operator Certification Exam. Contact us at
844.TEREX4U to setup testing certification for your
operators.***



WORKS FOR YOU.™

Bullet Tooth Rock Auger (BTR)



Key Product Features:

- Standard Heavy Duty 1" Flighting
- Extra Heavy Duty 1 1/2" Flighting available
- Square Drive Pilot bit
- Flighting pitch is engineered to enhance material flow from the tooth cutting area to increase productivity.
- Tooth angles and location are precisely controlled to improve tooth penetration providing superior productivity and tooth life.
- Pilot bits 65342191 for 12" diameter and smaller, TA002069 for 16" diameter and larger.
- Various sizes, types of teeth, and pilot bits available

Application:



65342191



TA002069



65349086



TA001537



WORKS FOR YOU.™

Spiral Bullet Tooth Auger (BTRSP)

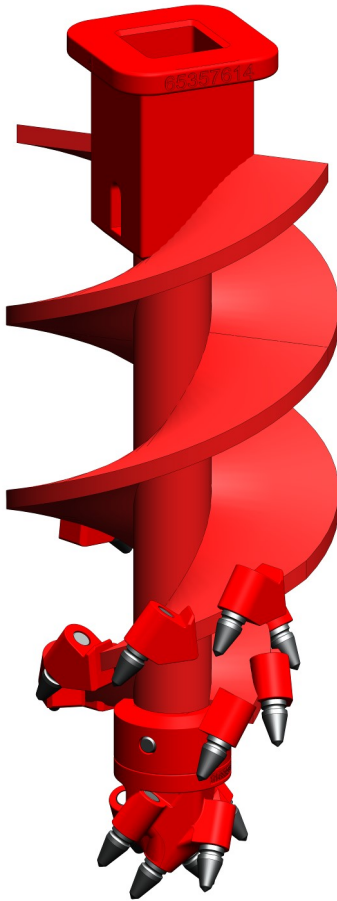

Key Product Features:

- Standard Heavy Duty 1" Flighting
- Extra Heavy Duty 1 1/2" Flighting available
- Square Drive Pilot bit
- Flighting pitch is engineered to enhance material flow from the tooth cutting area to increase productivity.
- Tooth angles and location are precisely controlled to improve tooth penetration providing superior productivity and tooth life.
- Various sizes, types of teeth, and pilot bits available

Application:

Terex® Spiral Bullet Tooth Rock Augers are designed with a unique tooth pattern that distributes the cutting action evenly. They can be used in virtually any ground conditions, with all of the standard Terex tooth offerings.



65353918



TA001537

Step/Blade Auger

Key Product Features:

- Standard Heavy Duty 1" Flighting
- Extra Heavy Duty 1 1/2" Flighting available
- 2 3/8" Threaded Carbide Pilot
- Flighting pitch is engineered to enhance material flow from the tooth cutting area to increase productivity.
- Tooth angles and location are precisely controlled to improve tooth penetration providing superior productivity and tooth life.
- Various sizes, types of teeth, and pilot bits available

Application:

Terex® Blade Augers are designed to improve drill footage in solid/non-fractured limestone and sandstone rock formations.

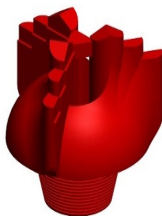
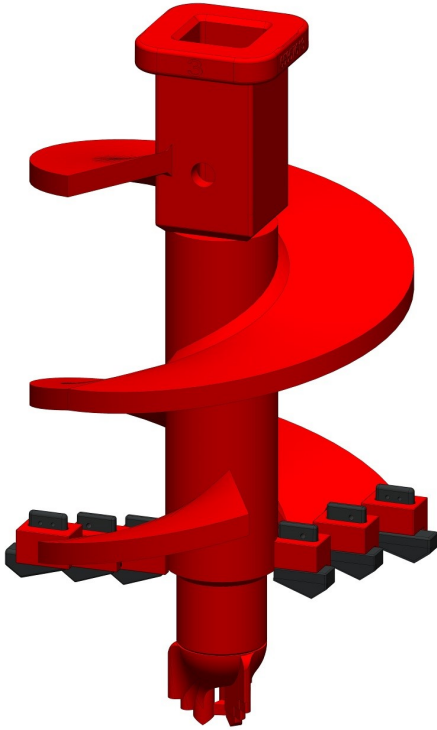

T16845

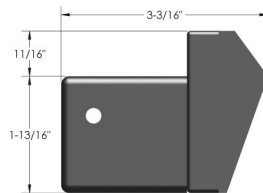

T16844

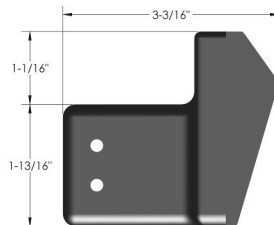

TA510184



WORKS FOR YOU.™

Dirt Auger

Key Product Features:

- Standard Heavy Duty 1" Flighting
- Extra Heavy Duty 1 1/2" Flighting available
- Square Drive Pilot Bit
- Flighting pitch is engineered to enhance material flow from the tooth cutting area to increase productivity.
- Tooth angles and location are precisely controlled to improve tooth penetration providing superior productivity and tooth life.
- Various sizes, types of teeth, and pilot bits available.

Application:

Terex® Dirt Augers are designed to improve drill footage in loose to compacted soils, stiff clay, loose gravel and soft shale.



65349023

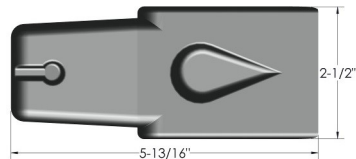

T29817

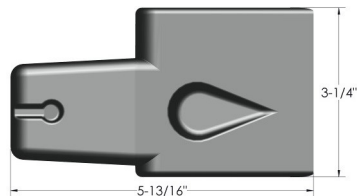

T29450



WORKS FOR YOU.™