

## Jaw Crushers

### DT Series

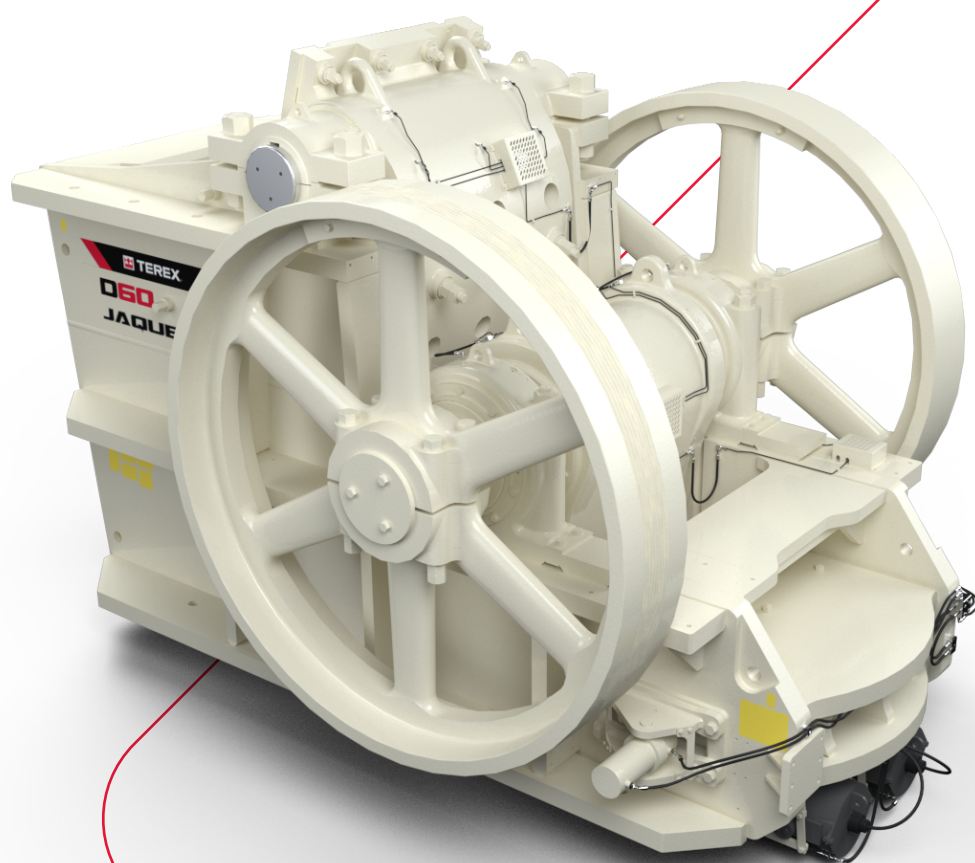

# Terex® Jaques Jaw Crushers

## DT Series

The Terex® Jaques Double Toggle jaw crushers feature large gape feed openings, high production and low operating costs. These rugged machines are manufactured with heavy duty parts for constant operation and long life. Our double-toggle jaw crushers suitable for hard and very hard rocks and abrasive applications

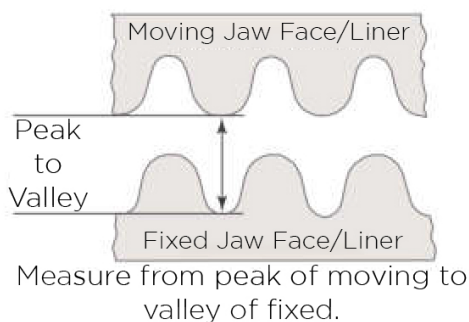

### Standard Features

- Hydraulic wedge jaw adjustment and tension rod on D42 & D60
  - Externally mounted hydraulics
  - Electric/hydraulic adjust unit
- Heavy-duty frame
  - Single-piece fabricated and stress relieved construction
  - Machined jaw liner support cheek plates
- Curved fixed and moving jawface liners
  - Provides optimum nip angle in fine crushing zone
  - Lifting points cast into jaw liners
  - Bolt and tapered nut retention of fixed jaws
  - Bolted retention of moving jaws
  - Replaceable jaw backing plates
- Robust swing jaw design
  - Cast steel pitman & swingstock
  - Large spherical self-aligning roller bearings
  - Large drop forged steel shaft
  - Swing jaw and main bearings suitable for SKF or equivalent monitoring systems
- Left hand flywheel grooved for V-belt drive with SPC belts
- Improved jawface & toggle seat life & reduced power vs single toggle

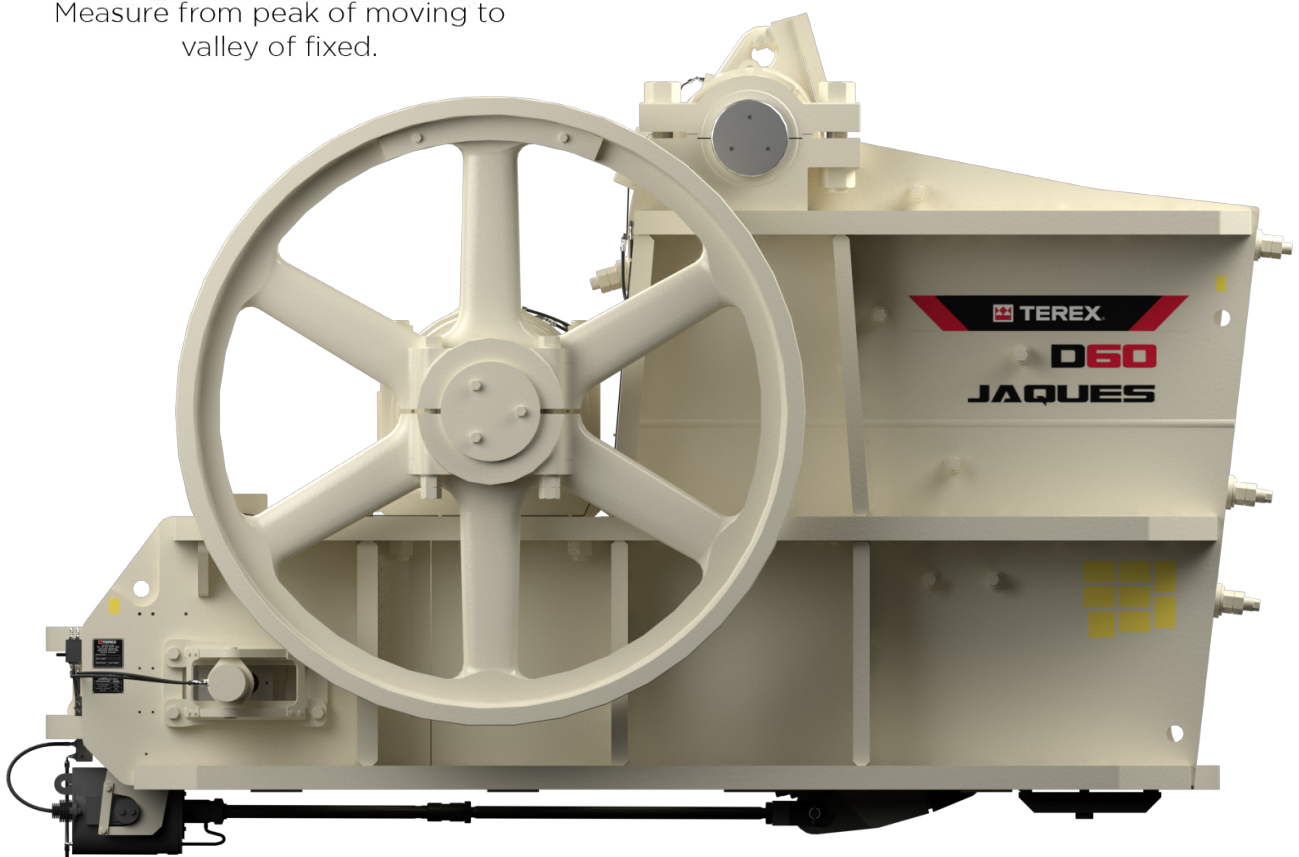

Motor	Size	Approximate Weight in kg			Approximate Throughput					Speed rpm	In- stalled Power	Vee Pulley
	Feed Opening mm	Total Weight	Weight Heaviest Portion Frame	Weight Swingstock with Jaws	Closed Side & Typical Throughput mm metric tph at 1.6t/m³ bulk density							
					100	114	152	178	203			
D42	1070 x 915 mm 42 x 36"	49,500	21,500	6,130	180- 210	210- 240	280- 320	345- 380	380- 430	200	110	1965PCD 6 Grooves
D48	1220 x 1070 mm 48 x 42"	71,300	39,500	13,000		300- 340	370- 410	440- 500	530- 600	175	132	1965PCD 8 Grooves
D60	1525 x 1220 mm 60 x 48"	117,500	57,490	23,850		370- 420	460- 520	550- 620	625- 700	175	160	3025PCD 8 Grooves

## Dimensional Drawings

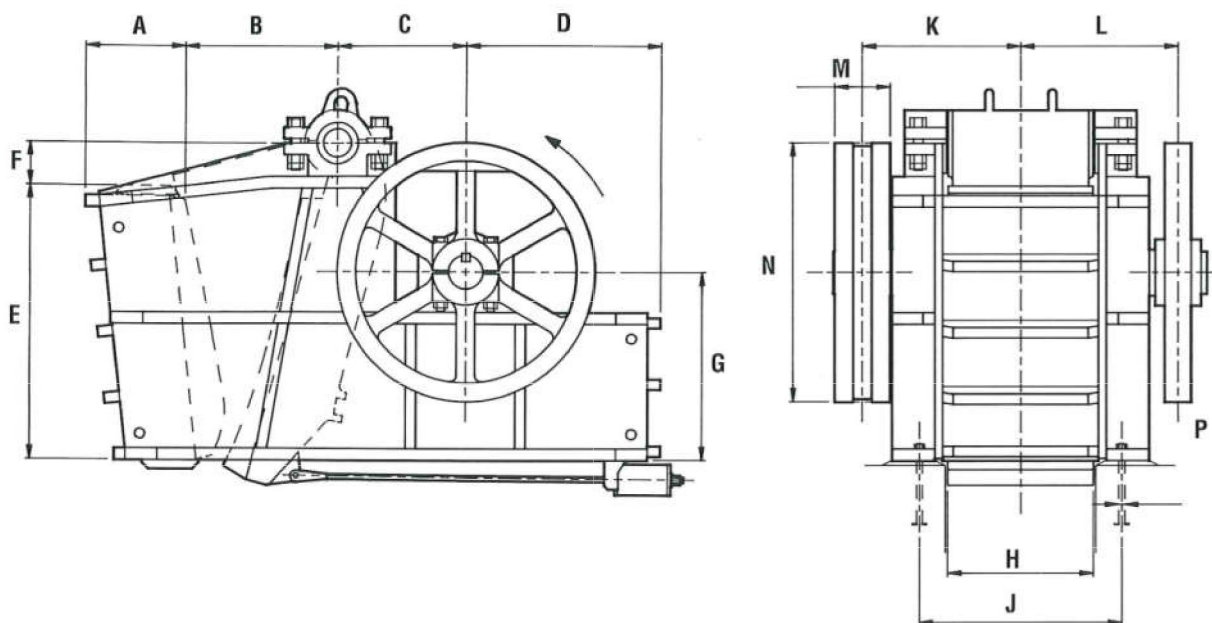

Approximate Overall Dimensions	1070 x 915 mm 42 x 36"	1220 x 1070 mm 48 x 42"	1525 x 1220 mm 60 x 48"
A	746	806	992
B	1175	1429	1481
C	991	102	1254
D	1499	1661	2048
E	2102	2470	2731
F	324	425	432
G	1438	1556	1842
H	1118	1270	1588
J	1550	1702	2134
K	1213	1322	1619
L	1213	1322	1619
M	425	394	533
N	1981	1981	3048
P	44	64	64

## Optional Equipment

- Drive package (integral - machine mounted) including motor, V-belts, and guards
- Automatic lubrication for bearings and seals
- Bearing temperature and condition monitoring sensors or provision for sensors
- Jaw liner profiles
- Vibration isolation mounts
- Hydraulic toggle
- Shim adjust (standard on D48)
- Multi piece frame D60

#### Australia

##### Melbourne & Victoria

133 Logis Boulevard  
Dandenong South, VIC 3175  
Tel: +61 3 8794 4100  
Fax: +61 3 9706 7810

##### Sydney & New South Wales

114 Hassall Street  
Wetherill Park, NSW 2164  
Tel: +61 2 9604 6524  
Fax: +61 2 9604 9368

##### Brisbane & Queensland

585 Curtin Avenue East  
Eagle Farm, QLD 4009  
Tel: +61 7 3630 0866  
Fax: +61 7 3630 1097

##### Perth & Western Australia

4 Miles Road  
Kewdale, WA 6105  
Tel: +61 8 6254 4100  
Fax: +61 8 9350 5534

[www.terexjaques.com](http://www.terexjaques.com)

[jaques@terex.com](mailto:jaques@terex.com)

Product specifications and prices are subject to change without notice or obligation. The photographs and/or drawings in this document are for illustrative purposes only. Refer to the appropriate Operator's Manual for instructions on the proper use of this equipment.

Failure to follow the appropriate Operator's Manual when using our equipment or failure to act responsibly may result in serious injury or death.

The only warranty applicable to our equipment is the standard written warranty applicable to the particular product and sale, and Terex makes no other warranty, express or implied. Terex, the Terex Crown design, Cedarapids, Canica, Simplicity, Jaques, El-Jay and Rollercone are trademarks of Terex Corporation or its subsidiaries. All rights are reserved. © July 2020